

*S*unseeker motoryachts
introducing the 80 Yacht

Eighty 80



TRULY GLOBAL

Sunseeker 80 Yacht - Standard specifications

1 Construction

Hand-laid GRP
Gel coat including stripes
Vinylester skin coat with powderbound mat
Stitched multi-axial reinforced single skin bottom
Balsa cored hull topsides
PVC foam cored deck and superstructure
Hull stiffened with longitudinal stringers supported by transverse bulkheads and floors

2 Flybridge

Self-draining cockpit
Acrylic deflecting spray screen
Seating areas
Storage lockers under seating
Teak dining tables (natural finish)
Upholstered sunbathing area forward
Stainless steel aft safety rails
Glass holders
Wetbar unit
Sink in wetbar unit
Icemaker in wetbar unit
Fridge in wetbar unit
Ceramic electric griddle in wetbar unit
Fire extinguisher
Deckwash outlet
Low-level flybridge lighting 24v
Radar arch structure
Radar chair with navigation light assembly
Overhead lighting on underside of radar arch 24v
Two pairs marine speakers (connected to dedicated CD/radio in saloon and controlled by remote keypad at flybridge helm)
Flagstaff and socket

3 Flybridge helm

Two helm seats
Hydraulic steering
Duplicate engine controls
Analogue engine instrumentation
Autopilot repeater
Radar/chart plotter with GPS repeater
Depth and speed multi display
VHF second station
Remote spotlight control
Magnetic compass
Steering indicator
Trim tab control
Horn control
Radio/CD remote keypad
Waterproof plug and socket 12v

4 Deck

Fittings all in 316 stainless steel and chromed bronze
Pair stainless steel bow cleats and fairleads
Stainless steel spring cleats with chafing bars
Pair stern cleats and fairleads
Stainless steel pulpit and cockpit rails
Stainless steel fendering with rubber insert
Stainless steel bow roller with anchor stop and devil's claw
Single electric windlass (Lewmar V8) 24v, starboard side, foredeck control only
Anchor 80kg (galvanised)
Anchor chain 100 metres/328 feet (12mm diameter, galvanised)
Stainless steel bow plate
Deckwash with outlets forward and aft
Chain locker
Curved direct glazed safety glass windscreen

Pantograph windscreen wipers and washers
Fresh-water filler
Fuel fillers port and starboard
IMCO navigation lights
Remote controlled spotlight at bow
Skylight from VIP stateroom
Ensign staff and socket
Bow seat
Bow sunbathing pad
Glass holders
Storage lockers port and starboard

5 Aft cockpit

Teak-laid cockpit floor
Self-draining
Stairs to flybridge with teak treads
Aft fixed bench seating
Teak table (natural finish)
Stern safety gates
Engine room access hatch
2 x stern capstan winches (Lewmar C4) 24v and fairleads
Overhead cockpit lights 24v
Low-level courtesy lights 24v
Pair marine speakers connected to saloon
AV system with Bose PMCI remote
Wetbar unit
Fire extinguisher in wetbar locker
Coolbox in wetbar unit

6 Bathing platform

Teak-laid hydraulic lifting bathing platform
Stairs to aft cockpit with teak treads
Foldout stainless steel swimming ladder
Hot and cold hand-held swimming shower
Fresh-water marina connection
Television and telephone marina connection
Access to crew quarters
Dockside AC connection 1 x 100 amp
Glendinning Cablemaster
Euro spec only:
hydraulic telescopic gangway

7 Saloon and dining

Stainless steel framed sliding door to aft cockpit
Sliding patio door curtains with tie back
Sofa seating with storage in base
Armchair
Coffee table
Scatter cushions
Flatscreen television (40") on rise and fall
DVD/CD/radio surround-sound system with five speakers and sub woofer (Bose 28)
iPod docking station connected to surround sound system
Control head for flybridge CD/radio
Air conditioning
Side windows with blinds
Drinks cabinet with glassware stowage for eight (8 x champagne, 8 x whisky, 1 x decanter)
Halogen overhead lighting 24v
Double AC sockets
Table lamp
Dining table
8 x free-standing dining chairs
Storage cupboards
Fitted carpet

8 Galley

American style fridge/freezer with ice maker
4-ring ceramic hob AC
Hob extractor AC
Oven AC

Small microwave AC
Slimline dishwasher AC
Stainless steel sink
Hot and cold water
Rubbish bin
Crockery set (8 place settings)
Cutlery set (8 place settings)
Side window
Storage consisting of cupboards, drawers and top-box lockers
Halogen overhead lighting 24v
Lighting under top box lockers 24v
Double AC sockets
Air conditioning
Fire blanket
Fire extinguisher
First aid kit
Manual side opening door to port side deck

9 Covers

Windscreen sunscreen
Flybridge instrument cover
Euro spec only: aft cockpit camper cover with windows

10 Main helm console and observation area

2 x upholstered helm seats with electric operation
Console with walnut effect fascia
Hydraulic power steering
Radar/chart plotter with GPS Autopilot
Depth and speed displays
VHF radio dual station
Magnetic compass
Horn control
Switch panels
Trim tab controls
Rudder indicator
Analogue engine instrumentation
Fresh water gauge
Fuel gauge
Cigar lighter
Main control and monitoring panel (AC/DC) with generators control
Windscreen wiper and washer controls
Glass holder
Screen demister
Fire extinguisher
Manual side opening door to starboard side deck
Sofa seat on port side
Double AC socket (port side)
Staircase forward leading to cabins
Fitted carpet

11 Forward VIP stateroom

Double berth
Foam mattress for berth
Storage beneath berth
Drawers in berth end
Bedside lights 24v
Dressing table
Low back chair for dressing table
Air conditioning
Flatscreen television (32") on bulkhead
DVD/CD player with two speakers
Halogen overhead lighting 24v
Two fixed portholes on each side with blind
Skylight with blind
Double AC socket
Fitted carpet
Doors to en suite and walk-in wardrobe

12 Forward VIP walk-in wardrobe

Hanging rails
Shelves
Mirror
Halogen overhead lighting 24v
AC socket
Fitted carpet
Door to stateroom

13 Forward VIP en suite

Tecma toilet 24v
Vanity top and flooring
Ceramic washbasin
Taps and accessories (toothbrush and glass holder, soap dispenser, towel rails and towels)
Separate shower compartment
Acrylic folding shower door
Air conditioning outlet
Extractor fan
Mirror
Shelved cupboard
Halogen overhead lighting 24v
Opening porthole with mosquito screen and venetian blind
Shaver socket 240/110v
Door to stateroom

14 Lower deck lobby

Stairs leading down from main deck saloon area
Storage cupboard below stairs
Halogen overhead lighting 24v
Double AC socket
Fitted carpet
Large bilge access hatch
Doors leading to lower deck guest accommodation

15 Master stateroom

Double berth
Foam mattress for berth
Storage beneath berth
Drawers in berth end and sides
Bedside units with storage
Bedside lights 24v
Dressing table
Low back chair for dressing table
Sofa
Air conditioning
Halogen overhead lighting 24v
Table lamp
Large windows with blind on each side
Double AC sockets
Flatscreen television (32") on bulkhead
DVD/CD/radio surround-system with two speakers and sub woofer (Bose 321)
Fitted carpet
Doors to en suite and walk-in wardrobe

16 Master walk-in wardrobe

Hanging rails
Shelves
Halogen overhead lighting 24v
AC socket
Fitted carpet
Door to stateroom

17 Master en suite

Tecma toilet 24v
Vanity top and flooring
Ceramic washbasin
Taps and accessories (toothbrush and glass holder, soap dispenser, towel rails and towels)
Separate shower compartment
Acrylic folding shower door

Extractor fan
Air conditioning outlet
Mirror
Halogen overhead lighting 24v
Opening porthole with mosquito screen and venetian blind
Shaver socket 240/110v
Door to stateroom

18 Starboard guest cabin

Two single berths
Foam mattresses for berths
Under berth stowage
2 x reading lights 24v
Wardrobe
Air conditioning
Halogen overhead lighting 24v
Porthole with blind
Double AC socket
Flatscreen television (19")
DVD/CD player with two speakers
Fitted carpet
Doors to en suite and lobby

19 Starboard guest en suite/day head

Tecma toilet 24v
Vanity top and flooring
Washbasin
Taps and accessories (toothbrush and glass holder, soap dispenser, towel rails and towels)
Separate shower compartment
Acrylic folding shower door
Extractor fan
Air conditioning outlet
Vanity unit
Mirror
Shelved cupboard
Halogen overhead lighting 24v
Opening porthole with mosquito screen and venetian blind
Shaver socket 240/110v
Doors to crew lobby and engine room

20 Port guest cabin

Two single berths
Foam mattresses for berths
Under berth stowage
2 x reading lights 24v
Wardrobe
Air conditioning
Halogen overhead lighting 24v
Porthole with blind
Double AC socket
Flatscreen television (19")
DVD/CD player with two speakers
Fitted carpet
Doors to en suite and lobby

21 Port guest en suite

Tecma toilet 24v
Vanity top and flooring
Washbasin
Taps and accessories (toothbrush and glass holder, soap dispenser, towel rails and towels)
Separate shower compartment
Acrylic folding shower door
Extractor fan
Air conditioning outlet
Vanity unit
Shelved cupboard
Halogen overhead lighting 24v
Opening porthole with mosquito screen and venetian blind
Shaver socket 240/110v
Door to guest cabin

22 Stern crew lobby

Access door from stern
Storage
Washer/dryer AC
Air conditioning
AC socket
Halogen overhead lighting 24v
Doors to crew cabins and crew toilet/shower

23 Starboard crew cabin

Large single berth
Foam mattress for berth
Reading lights 24v
Air conditioning
Halogen overhead lighting 24v
Double AC socket
CD/radio with two speakers
Fitted carpet
Opening porthole with mosquito screen and curtains
Door to crew lobby

24 Port crew cabin

Twin bunk berths
Foam mattresses for berths
Reading lights 24v
Air conditioning
Halogen overhead lighting 24v
Double AC socket
Fitted carpet
Opening porthole with mosquito screen and curtains
Door to crew lobby

25 Crew toilet/shower

Tecma toilet 24v
Washbasin
Shower cubicle with bi-fold shower door
Mirror
Vanity unit
Halogen overhead lighting 24v
Shaver socket 240/110v
Doors to crew lobby and engine room

26 Engine compartment and ancillaries

Soundproofing throughout
Fuel filters/water separators to engines
Fuel filters/water separators to generators
FM200 manual/automatic fire extinguishing system combined with engines, generators and fans shutdown
Automatic bilge and flood pumps with high level alarms
Air extraction fans AC
Generator exhaust silencers and water separators
Engine exhaust dry risers and water injection
Strainers to all raw water inlets

27 Electrical system

Euro spec only: 2 x 20kW @ 50Hz slow speed Kohler generators with underwater silent exhaust and sound box
US spec only: 2 x 23kW @ 60Hz slow speed Kohler generators with underwater silent exhaust and sound box
Dockside AC connection 1 x 100 amp
Glendinning cablemaster
Galvanic isolator
Semi-automatic AC power management system
24v and 12v DC electrical system with full circuit breaker protection
8 x engine batteries 24v circuit
8 x domestic batteries 24v circuit



2 x generator batteries 12v circuit
 Alternator split charging system
 Remote battery switches controlled from aft cockpit locker
 2 x 95 amp battery charger for 24v circuits
 70 amp battery charger for 12v circuits
 Immersion heater for calorifier
 AC sockets throughout the boat
 24v hand light and cable
 Fire detection system with sensors in all cabins and monitoring beside main helm position

28 Underwater gear

NAB 5 blade propellers
 Bronze (MB2) P-brackets
 75mm Temet 25 propeller shafts
 Self-aligning shaft seal with spare seal
 High-performance bronze rudders
 Valves to all underwater skin fittings
 Full cathodic bonding system to zinc anodes
 Stainless steel trim tabs
 Hydraulic bow thruster
 Hydraulic stern thruster
 Antifouling

29 Systems

Hydraulic power steering
 Electric toilet system (Tecma 24v) with two-switch control
 Toilets discharging overboard or to black water tank
 Black-water tank discharging to dockside or overboard through discharge/macerator pump (24v)
 Aluminium fresh water tank with electric sending unit
 Integral GRP fuel tank with electric sending unit
 Water pressure system (24v)
 Hot-water tank, 200 litre (calorifier with 2 x 2kW immersion heaters)
 Hot-water circulating pump, AC
 Washbasins, showers and air conditioning fan coils to drain to grey water tank
 Chilled water air conditioning system (reverse cycle), AC
 Bilge pumping system (24v)
 FM200 manual/automatic fire extinguishing system combined with engines, generators and fans shutdown
 Auxiliary hydraulics for trim tabs and platform (24v)

30 Miscellaneous

Retractable boat hook
 6 x docking lines (6 x 15 metre, 20mm diameter, black)
 1 x tender line (1 x 10 metre, 10mm diameter, black)
 8 x fenders (F7, 15" x 41", white)
 8 x fender ties (8 x 3.5 metre, 10mm diameter, black)
 Flagstaff with line
 Pennant mast with pennant flag
 Mosquito screens for openable portlights
 Vacuum cleaner
 Spare bulbs
 Small toolkit
 6 x towel sets
 First aid kit
 Fire blanket
 Leather cleaning kit
 Lead lamp
 Deckwash fitting and hose reel
 Portable fire extinguishers

US specification includes:

Upgraded generators
 US electrical specification
 US specification appliances

PRINCIPAL CHARACTERISTICS

Classification	CE	
Length overall – (incl. pulpit and transom platform)	24.44m	80' 2"
Beam – (maximum)	6.03m	19' 9"
Draft – (@ full load incl. props)	1.90m	6' 3"
Displacement – (@ half load)	62000kg	136400lb
Fuel capacity	6000 litres	1586 US gal.
Fresh-water capacity	1200 litres	317 US gal.
Black-water capacity	435 litres	115 US gal.
Propulsion	Twin fixed-pitch propellers	
Generators – standard	2 x 20kW @ 50Hz single phase (Euro) 2 x 23kW or 28kW @ 60Hz single phase (US)	
Maximum speed	up to 30 knots*	
Cruising speed	up to 24 knots*	
Range	up to 350 nautical miles*	

All principal characteristics and specifications are provisional and subject to final specification.

LAYOUT OPTIONS

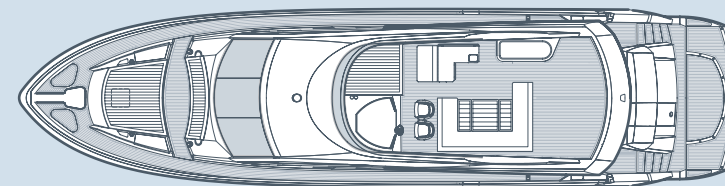

Flybridge

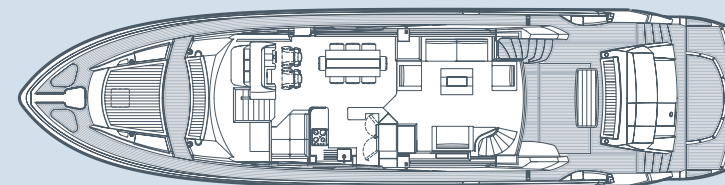

Main deck

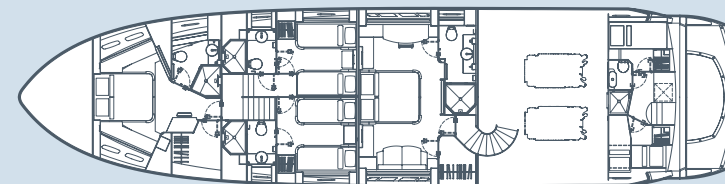

Lower deck

Other layout options available





TRULY GLOBAL

www.sunseeker.com

Awards

Sunseeker's success over the years is clearly underlined by the following list of national and international awards and achievements.

2010	European CEO Corporate Lifestyle Awards	Best Luxury Yacht Company	2004	Sydney Boat Show	Best Marina Display
2010	ShowBoats Design Awards	Predator 130 'Evil Zana' – Winner (Naval Architecture)	2003	Australian Marine Awards	Manhattan 56, Award for Excellence
2010	Quintessentially Awards	Yacht charter of the year	2003	Australian Marine Awards	Predator 68, Best Imported Non-Trailable Yacht
2010	Sydney Boat Show	Boating Industry Association of NSW – Best Marina Display	2002	Entrepreneur of the Year Award	Robert Braithwaite MBE
2010	Sydney Boat Show	Boating Industry Association of NSW – Best Overall Display	2001	Best Power Design Award	105 Yacht, The Superyacht Society
2010	Asia Boating Awards	Predator 60 – Best Production Motor Yacht 51 to 80 feet	2001	Best Power Interior Award	105 Yacht, The Superyacht Society
2009	Sydney Boat Show	Display of Excellence	2001	President's Award	Southern California Marine Association
2009	Croatia Boat Show	Predator 92 Sport – best in class	2000	Queen's Award for Enterprise	Continuous innovation and development
2009	Croatia Boat Show	30 Metre Yacht – best in class	2000	The Times Exporter of the Year	Times Export Awards
2009	Croatia Boat Show	Best boat show stand	2000	Robb Report Award	Best of the Best, Boating and Sailing
2008	UK Motor Boat of the Year Awards	Manhattan 60	1999	Robb Report Award	Best of the Best, Boating and Sailing
2007	European Powerboat of the Year	Superhawk 43	1999	Motorboat of the Year	Predator 75, BT British Nautical Awards
2007	Asia Pacific Boating Awards	90 Yacht, Best of the Best	1998	Superyacht Design Award	Manhattan 74, Superyacht Design Awards
2007	Modern Boating Magazine	Portofino 47, Imported Powerboat of the Year	1998	Editor in Chief Awards	Yachts Magazine
2007	Australian Marine Industries Federation Awards	Predator 62, Imported Powerboat of the Year	1997	Lifetime Achievement Award	Robert Braithwaite MBE, RYA Awards
2007	Nominated by The Superyacht Society	37 Metre Yacht 'The Snapper'	1996	Motorcruiser of the Year Award	RYA British Nautical Awards
2007	Queen's Award for Enterprise	International Trade	1996	Exporter of the Year Award	DCCI Export Awards
2006	Nominated for three Superyacht Awards	Predator 108 'SHIVER'	1995	Boat Builder of the Year Award	RYA/BMIF British Nautical Awards
2005	Australian Marine Industries Federation Awards	75 Yacht, Non-Trailable Boat Award	1994	Queen's Award for Export Achievement	Queen's Awards for Industry
2005	Australian Marine Industries Federation Awards	Portofino 46, Commendation	1992	Best in the World Award	Renegade 60, Boating Magazine
2005	Modern Boating, Power Boat of the Year Awards	Predator 68, Imported Powerboat of the Year	1990	Exporter of the Year	SW International Business Awards
2005	Boats.com Marine Industry Web Awards	Manufacturers Category for www.sunseeker.com	1989	Queen's Award for Export Achievement	Queen's Awards for Industry
2004	Sydney Boat Show	Best Overall Display	1987	Queen's Award for Export Achievement	Queen's Awards for Industry



Sunseeker International Limited has CE Approval which is compulsory for all boats with a LOA of 24m and below when sold in the EU.

*Every attempt has been made to give accurate information, but performance and range figures are estimates given as a guide only. Dirt or growth on the hull, tuning of the engines, size, make of engines fitted, damage to propellers, the temperature of the air and water, the weight of fuel, water, stores, number of people, propeller pitch, quality of fuel and other matters, can all affect a boat's performance and range. For these and other reasons we can give no performance, range or other guarantees, and neither such guarantees nor anything contained herein constitutes an offer of contract or any representation or agreement, or may otherwise be relied upon. The photographs and artist's impressions in this brochure are from existing models in the Sunseeker range. There may be items shown in these photographs and artist's impressions that are not included in the standard inventory of the models shown. Specifications contained in this brochure are provisional only and should not be relied upon and may refer to models only intended for sale in a particular territory and not generally. No guarantee is given that any model will be available in any territory; however by contacting us we can advise you of models that are likely to be available in each territory. In some examples herein we have referred to measurements, specifications or other details applicable to a particular territory and no guarantee is given that these are applicable to your territory. Actual specifications will be provided when a sales order or enquiry is placed with us or our approved Sunseeker distributor. Specifications for models sold in different markets may vary and specifications and models may be changed or withdrawn at any time without prior notice. The individual specification for each vessel will be agreed as part of the sale contract between the purchaser and the Sunseeker distributor. Distributors are independently owned and operated entities, and therefore Sunseeker distributors are not owned by Sunseeker International Limited or any subsidiaries or other related entity of this company nor are they their agents. Therefore they have absolutely no authority to commit Sunseeker International Limited, or any subsidiary or other related entities of Sunseeker International Limited to any pledge, contract or agreement in any form or by any means unless first accepted in writing by Sunseeker International Limited. For ease of reference we have, in some cases, referred to "we" or "Sunseeker" and these terms should be taken to mean Sunseeker International Limited.